



## Xcelerator Category 6 Jacks

Category 6 Component  
DTE Power Compliant  
Keystone Design  
Quicklace™ Combination  
Exclusive 1-Punch Termination Tool

### Termination Towers

- Easy pair splitting
- Simple lacing
- Fast punch-down

### Universal Wiring

Two distinct labels eliminates wiring confusion, T568B or T568A



### Stuffer Cap

- Secure strain relief
- Positive "snap" latching

### FEATURES

- Center balanced to Category 6 plug specifications
- Positive PSACR beyond 300 MHz (channel)
- 4+Gbs capacity within the Bandwidth of 1-250MHz (channel)
- Exceeds IEEE 802.3af DTE Power specification to 4X the standard
- Exceeds IEEE 802.3ab Gigabit Specification to  $< 1 * 10^{-13}$
- Backwards compatible to Category 3, 5 and 5e
- IDC pair splitting tower allows for minimum disruption to cable twist
- Exclusive 1-Punch termination tool reduces termination time by 75%
- Compatible with standard 110 termination tools
- Standard HPW keystone mounting
- HPW Icon compatible
- 13 different colors

### SPECIFICATIONS

#### Mechanical

- ◆ Construction Materials:
  - Housing: High impact thermoplastic (UL 94 V-0)
  - Stuffer cap: Lexan (UL 94 V-0)
  - Dust cover: Polypropylene
- ◆ Nose Contacts
  - Material: Beryllium copper with a minimum of 50 micro-inch gold plating over nickel under plating
  - 2,000+ mating cycles with FCC compliant 8-position plug
  - Confirmed contact performance over full range of (FCC Spec) deflection limits
  - Min. contact force 100 grams with FCC compliant 8-position plug
  - Accepts FCC compliant 6-position plugs
- ◆ IDC 110 Contacts
  - Material: Phosphor bronze with 100 micro-inch tin lead 60/40 plating over nickel under plating
  - 20+ IDC terminations for same size AWG
  - Accommodates 22 to 26 AWG/Solid

### STANDARDS/LISTINGS/VERIFICATIONS

- ANSI/TIA/EIA-568-B.2-1 (Category 6)
- Designed to meet/exceed proposed ANSI/TIA/EIA-568-B.2-8 (DTE Power Component specifications)
- Designed to meet/exceed proposed ANSI/TIA/EIA-568-B.1-6 (DTE Power Channel specifications)
- IEEE 802.3af DTE Power and MDI verified
- IEEE 802.3ab Gigabit Ethernet Verified
- ETL Verified Category 6 component
- ETL Total Solutions
- UL Listed 1863
- CSA Certified
- FCC part 68.5, subpart F compliant
- IEC-60603-7-4 compliant
- ISO 11801 2nd Edition, Class E Compliant



Xcelerator™ Category 6 modular jacks (XJ6) deliver unmatched component performance, leading the structured cabling industry with the first ETL tested Category 6 component compliant, modular jack. The XJ6 is also the first modular jack to undergo extreme DTE Power testing to 4x the standard handling continuous DTE power, exceeding the IEEE 802.3af standard without failure or any substantial increase in temperature.

The XJ6 supports network convergence protocols by delivering maximum bandwidth and extended reliability for all LAN, multimedia and PoE (Power over Ethernet) applications such as VoIP and IP-Video.

The QuickLace™ termination process combined with the exclusive 1-Punch tool delivers the fastest termination in the structured cabling industry. The innovative combination reduces termination time by 75% and provides a consistent termination every time.

The XJ6 easily installs into all HPW Infin-e-Station™ products, including rear-loading plates, front-loading modules and frames. Xcelerator jacks can be used in multimedia configurations with our SF (Snap Fit) connectors customizing all workstations, consolidation points and telecommunication closets.

### APPLICATIONS

- ▲ IEEE 802.3:
  - 1000BASE-T Gigabit Ethernet
  - 100BASE-T
  - 10BASE-T
- ▲ 155Mbps/1.2Gbps ATM
- ▲ DTE Power Applications
- ▲ VoIP
- ▲ Analog Video
- ▲ Digital video
- ▲ High-resolution 3-D modeling
- ▲ Data centers
- ▲ Company intranets
- ▲ On-line document publishing
- ▲ Real-time video to the desktop
- ▲ Multi-Gigabit Technologies

**ORDERING INFORMATION**

**Xcelerator™ Category 6 Jacks**

Unit Package	1 per Bag	25 per Bag
Order Qty.	Carton of 25	Bag of 25
Color	Catalog No.	Catalog No.
Black	<b>HXJ6BK</b>	<b>HXJ6BK25</b>
Blue	<b>HXJ6B</b>	<b>HXJ6B25</b>
Electric Ivory	<b>HXJ6EI</b>	<b>HXJ6EI25</b>
Gold	-	<b>HXJ6GL25</b>
Gray	<b>HXJ6GY</b>	<b>HXJ6GY25</b>
Green	<b>HXJ6GN</b>	<b>HXJ6GN25</b>
Office White	<b>HXJ6OW</b>	<b>HXJ6OW25</b>
Orange	<b>HXJ6OR</b>	<b>HXJ6OR25</b>
Purple	-	<b>HXJ6P25</b>
Red	<b>HXJ6R</b>	<b>HXJ6R25</b>
Telco Ivory	<b>HXJ6TI</b>	<b>HXJ6TI25</b>
White	<b>HXJ6W</b>	<b>HXJ6W25</b>
Yellow	<b>HXJ6Y</b>	<b>HXJ6Y25</b>

**ACCESSORIES**

**Icon System**

Identify the work area or the cross connect with Hubbell's new icon system. The new icons are offered in packs of 100 blank or with a computer or telephone molded in. Customize each blank icon with our preprinted icon booklet. Each booklet has 11 pages with numerous labels ranging from A to G, FAX to Data, providing a multitude of options, which adheres to ANSI/TIA/EIA-606-A.

			
Color	Blank	Computer	Telephone
Black	<b>IBK100</b>	<b>IBK100C</b>	<b>IBK100T</b>
Blue	<b>IB100</b>	<b>IB100C</b>	<b>IB100T</b>
Brown	<b>IBN100</b>	<b>IBN100C</b>	<b>IBN100T</b>
Electric Ivory	<b>IEI100</b>	<b>IEI100C</b>	<b>IEI100T</b>
Gray	<b>IGY100</b>	<b>IGY100C</b>	<b>IGY100T</b>
Green	<b>IGN100</b>	<b>IGN100C</b>	<b>IGN100T</b>
Orange	<b>IOR100</b>	<b>IOR100C</b>	<b>IOR100T</b>
Purple	<b>IP100</b>	<b>IP100C</b>	<b>IP100T</b>
Red	<b>IR100</b>	<b>IR100C</b>	<b>IR100T</b>
White	<b>IW100</b>	<b>IW100C</b>	<b>IW100T</b>
Yellow	<b>IY100</b>	<b>IY100C</b>	<b>IY100T</b>

**DIMENSIONS**

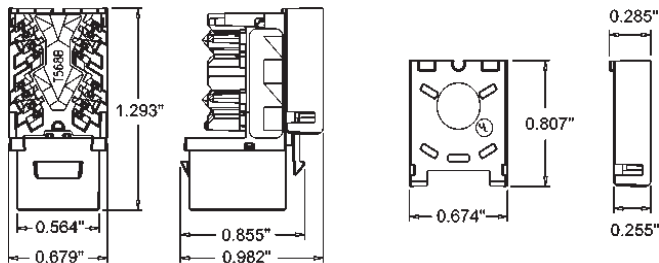

**1-PUNCH INSTRUCTIONS**

The "1-Punch" Tool and Xcelerator™ Jacks are made for each other. Designed to punch-down all 4-pairs consistently and cut off all conductors in "1-Punch". This tool saves valuable installation time over traditional single-blade tools that require multiple cycles.

This tool should be used exclusively with Xcelerator™ jacks and with the Hubbell Premise Wiring "Jack Knuckles" termination aid.

**Five easy steps get the job done:**

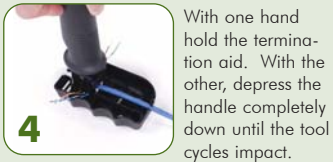
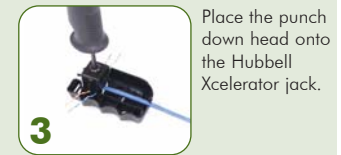
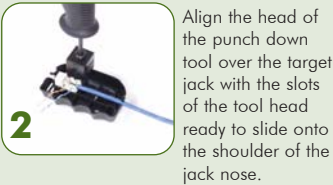
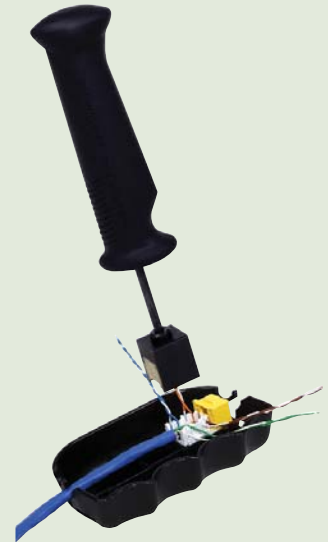

**ORDER INFORMATION - 1-PUNCH TOOL**

**Delivery**

- 1 Impact handle
- 1 Punch-down head for Xcelerator™ jacks
- 1 "Jack Knuckles" termination aid

Description	Catalog No.
1-Punch Tool with head, blades and termination aid	<b>TX4P</b>

**ACCESSORIES**

Replacement 4-pair XJ head	<b>TX4PH</b>
Replacement 4-pair XJ blades	<b>TX4PHBL</b>
Jack Knuckles termination aid	<b>HXTA</b>
Snap-X termination puck (25-pack)	<b>HXTP25</b>
Xcelerator Hinged Dust Cover (25-pack)	<b>HXJDC25</b>



**Hubbell Premise Wiring**

HUBBELL INCORPORATED (Delaware)  
 14 Lord's Hill Road • Stonington, CT 06378-0901 • (860) 535-8326 • 800-626-0005  
 Fax: (860) 535-8328 • Internet site: <http://www.hubbell-premise.com>

**Worldwide Locations**

Hubbell Premise Wiring, Asia Pacific	852-2836-7131	Fax: 852-2836-7132	Hubbell de Mexico, S.A. de C.V.	52-5-559-5304	Fax: 52-5-559-5885
Hubbell Canada Inc.	905-839-1138	Fax: 905-839-9108	Hubbell Premise Wiring, Middle East	971-4-393-4192	Fax: 971-4-393-4194
Hubbell Premise Wiring, China	86-21-63090119	Fax: 86-21-63090122	Hubbell Premise Wiring, Puerto Rico	787-720-7185	Fax: 787-789-2796
Hubbell Premise Wiring, Europe	44-(0)1234-848550	Fax: 44-(0)1234-856190	Hubbell-Taian Co., Ltd., Taiwan	886-2-(0)2515-0855	Fax: 886-2-(0)2515-0899
Hubbell Int'l. Inc., Korea Branch	82-2-(0)2607-1363	Fax: 82-2-(0)2603-7386	Hubbell Incorporated, Turkey	90-216-414-8147	Fax: 90-216-414-8148
Hubbell Premise Wiring, Latin America	305-251-4236	Fax: 305-251-4087	Hubbell Premise Wiring, Venezuela	58-16-6807453	Fax: 58-281-2820323